

118 Pump Assembly

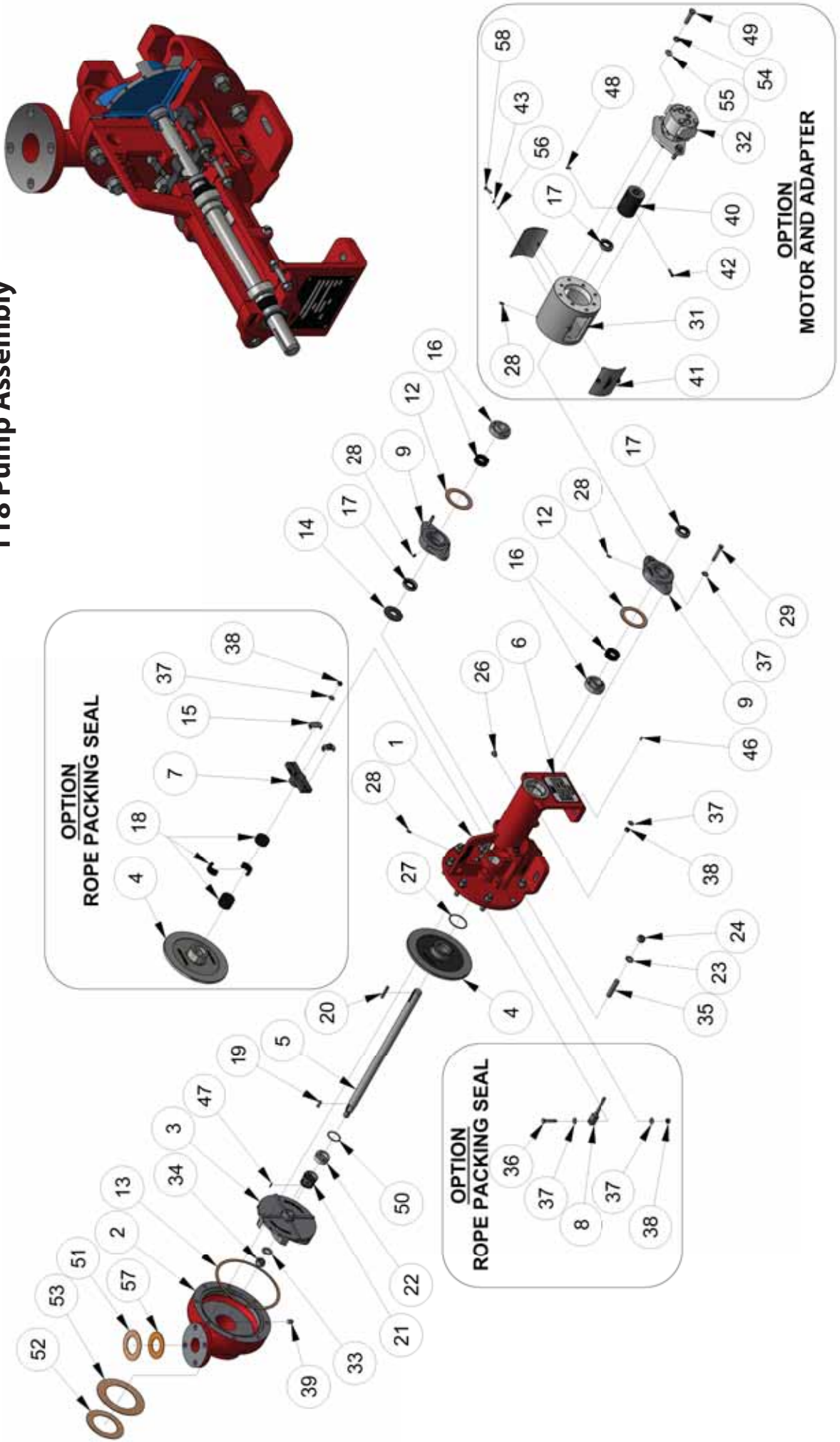

118 Pump Assembly Parts List			118 Pump Assembly Parts List (Continued)		
Item	Qty	Part Number	Description	Material	Material
Standard Pump Selection					
1	1	TT001	118 Pump Pedestal	Ductile Iron	
5	1	TT005	118 Shaft	Stainless Steel	Ductile Iron
6	1	TT006	Pump Serial Plate	Aluminum	Ductile Iron
9	2	TT009	118 Bearing Cap	Stainless Steel	
12	2	TT012-150	118 Bearing Cap Gasket	PTFEEn1550	
13	1	TT013	118 Housing Gasket	PTFEEn1550	
14	1	TT014	118 Pump Splasher	Ductile Iron	CR26 58HRC
16	2	TT016	118 Pump Shaft Bearing & Collar	Steel	
17	2	TT017	118 Grease Seal	NBR Nitrile Rubber and Steel	
19	1	TT019	118 Impeller Key	Steel	Ductile Iron
20	1	TT020	118 Coupling Key	Steel	Ductile Iron
21@	1	TT021	Mechanical Seal Assembly	Steel	
22@	1	TT042	Sleeve, Mechanical Seal	Steel	
23	8	MPH-W-00010	Washer, Lock, 5/8"	Steel	CR26 58HRC
24	8	MPH-N-00005	Hex Nut, 5/8"	Steel	CR26 58HRC
26	1	TT043	Pump Vent, 1/4"	Nylon 6/6	
27@	1	MPH-R-00002	O-Ring	Buna-n	
28	3	MPH-G-00001	Lubricating Grease Nipple, (Zerk)	Stainless Steel	
29	4	MPH-B-00009	Hex Bolt, 3/8"	Steel	
33	1	MPH-W-00009	Washer, Flat, 3/4"	Steel	
34	1	MPH-N-00004	Nylon Lock Nut, 3/4"	Steel	
35	8	MPH-D-00001	Stud, 5/8"	Steel	
36	2	MPH-B-00007	Hex Bolt, 3/8"	Steel	
37	8	MPH-W-00004	Washer, Flat, 3/8"	Steel	
38	6	MPH-N-00010	Nylon Locknut, 3/8"	Steel	
39	1	MPH-U-00003	Square Head Drain Plug, 1/4"	Steel	
46	4	MPH-P-00001	Protruding Head Drive Pin Blind Rivet - 5/32"	Aluminum	
47	1	MPH-P-00002	Pin - Slotted Spring - 1/8"	Steel	
50@	1	MPH-R-00001	O-Ring	Buna-n	
51	1	TT046	1 1/2 Inch Flange Gasket (Used on 1 1/2X2 Pumps)	PTFEEn1550	
51	1	TT047	2 Inch Flange Gasket	PTFEEn1550	
52	1	TT048	3 Inch Flange Gasket	PTFEEn1550	
53	1	TT049	4 Inch Flange Gasket	PTFEEn1550	
1-1/2 X 2 Housing and Impeller Selection - Standard or Hardened					
Standard Option					
2	1	TT002-152-04D	118 Pump - 1 1/2 X 2 Housing	Ductile Iron	
3	1	TT003-152-04D	118 Pump - RH 1 1/2 Impeller	Ductile Iron	
Hardened Option					
2	1	TT002-152-07	118 Pump - 1 1/2 X 2 Housing	CR26 58HRC	
3	1	TT003-152-07	118 Pump - RH 1 1/2 X 2 Impeller	CR26 58HRC	
2 X 3 Housing and Impeller Selection - Standard or Hardened					
Standard Option					
2	1	TT002-23-04D	118 Pump - 2 X 3 Housing	Ductile Iron	
3	1	TT003-23-04D	118 Pump - RH 2 X 3 Impeller	Ductile Iron	
Hardened Option					
2	1	TT002-23-07	118 Pump - 2 X 3 Housing	CR26 58HRC	
3	1	TT003-23-07	118 Pump - RH 2 X 3 Impeller	CR26 58HRC	
3 X 4 Housing and Impeller Selection - Standard or Hardened					
Standard Option					
2	1	TT002-34-04D	118 Pump - 3 X 4 Housing	Ductile Iron	
3	1	TT003-34-04D	118 Pump - RH 3 X 4 Impeller	Ductile Iron	
Hardened Option					
2	1	TT002-34-07	118 Pump - 3 X 4 Housing	CR26 58HRC	
3	1	TT003-34-07	118 Pump - RH 3 X 4 Impeller	CR26 58HRC	
Seal Selection - Rope Packing or Mechanical					
Rope Packing Seal Option - Standard or Hardened Option					
4#	1	TT004-04D	118 Pump - Rope Packing Seal Wear Plate	Ductile Iron	
4#	1	TT004-07	118 Pump - Rope Packing Seal Wear Plate	CR26 58HRC	
18#	1	TT018	118 Rope Packing Kit	Plastic and Graphite Yarn	
7#	2	TT007	118 Packing Gland	Ductile Iron	
8#	2	TT008	118 Gland Bolt	Ductile Iron	
15	2	TT015	118 Packing Gland Lock	Ductile Iron	
36	2	MPH-B-00007	Hex Bolt, 3/8"	Steel	
37	4	MPH-W-00004	Washer, Flat, 3/8"	Steel	
38	2	MPH-N-00003	Locknut, 3/8"	Steel	
Mechanical Seal Option - Standard or Hardened Option					
4@	1	TT004-5	118 Pump - Mechanical Seal Wear Plate	Ductile Iron	
4@	1	TT004-57	118 Pump - Mechanical Seal Wear Plate	CR26 58HRC	
Motor and Adapter Option					
17&	1	TT017	118 Grease Seal	NBR Nitrile Rubber and Steel	
31&	1	TT040	118 Pump Bearing Cap and Motor Mount Combo	Steel	
32&	1	SG001005	118 Motor (Keyed Shaft)	Steel	
49&	2	MPH-B-00008	Hex Bolt, 1/2"	Steel	
54&	2	MPH-W-00012	Washer, Lock, 1/2"	Steel	
55&	2	MPH-W-00001	Washer, Flat, 1/2"	Steel	
58&	4	MPH-S-00019	Hex Head Cap Screw 1/4"	Steel	
40&	1	MP-U322-00006	Coupling, SAE "B" Spline X 1.125" Dia. Shaft	Steel	
41&	2	TT041	118 Pump Hub Access Cover	Steel	
42&	1	MPH-S-00016	Socket Head Cap Screw 1/4"	Steel	
43&	4	MPH-W-00003	Lock Washer, 1/4"	Steel	
56&	4	MPH-W-00002	Washer, Flat, 1/4"	Steel	
48&	1	MPH-S-00018	Set Screw, 1/4"	Steel	
Options Reference:					
#	Used on Pumps Equipped with Rope Packing Seal Option Only				
@	Used on Pumps Equipped with Mechanical Seal Option Only				
&	Used on Pumps Equipped with Motor Adapter Option Only				